

Anchor channel type JTA K 38/17

JTA K 38/17

Load range 4.5 and 7.0 kN
6.3 and 9.8 kN

Weight with anchors: 1.95 kg/m⁵

Design resistance to Eurocode

$$F_{Rd} = perm. F \times 1.4$$

The design values of the load bearing capacities are shown in *italics* in the tables.

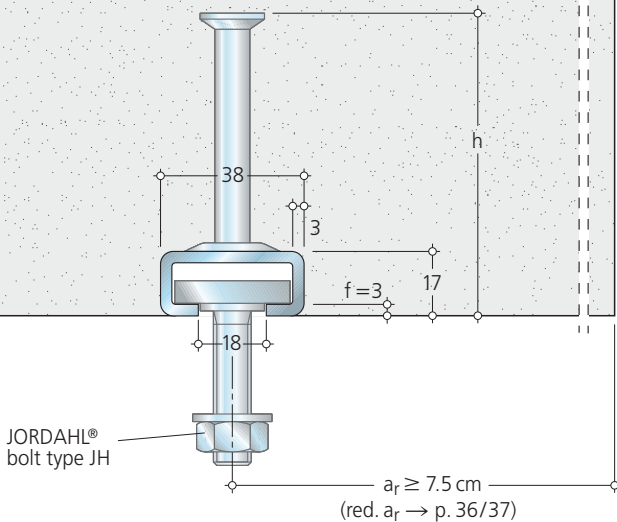

Accessories

Toothed strap JVB/18

Design in gv or A4
Types JVB-Z and JVB-ZS

→ p. 59

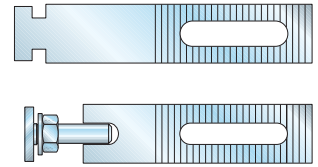

Brick tie JMA/18

Design in fv or A4

Nail anchor JNA/18

Design in fv

Lengths → p. 65

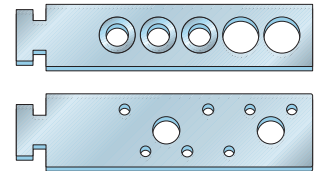

End anchor type E2

Design in fv or A4
Fixing bolt M 10
Empirical M_A = 20 Nm

Please order separately!

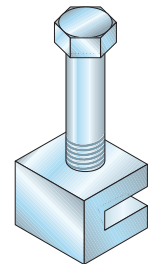

Type	JTA K 38/17	
Material Design	S235JR fv, wb	1.4401/1.4404/1.4571 ³⁾ (A4) 1.4301/1.4541 (A2) Round anchor A4
Permissible point load [kN]¹⁾ ≥ C 20/25	4.5/7.0 <i>6.3/9.8</i>	(3.5) ⁴⁾ <i>(4.9)⁴⁾</i>
Anchor design²⁾	R	R
Installation height h [mm]⁴⁾	80 (55)	80
Filler	Polystyrene filling (PS) or polyethylene filling (PE) (Supply not binding)	

- 1) Max. permissible load as per Building Approval. The second value applies to short pieces 100/150/200/250 mm. Permissible loads for the respective application → p. 33, C 20/25 Δ B 25. Special design K 38/17-200 A4 with anchor spacing ≤ 200 mm (perm. F = 7.0 kN).
- 2) Anchor design: R = round anchor (standard design).
- 3) Can also be supplied upon request in stainless steel 1.4529/1.4547 for corrosion resistance class IV.
- 4) With shortened anchor (bracketed values) outside the Building Approval. We design load bearing capacities dependent on edge spacings and concrete qualities on a project basis.
- 5) Weight per metre for mill finish steel (for galvanized profiles: weight per metre × 1,10) (for stainless steel: weight per metre × 1,02)

Lengths supplied: JTA K 38/17

	Length [mm]	Anchor (no.)	Anchor spacing s
Short pieces	100	2	50
	150	2	100
	200	2	150
	250	2	200
	300	2	250
	350 – 550	3	≤ 250
	600 – 800	4	≤ 250
	850 – 1050	5	≤ 250
Cut lengths	1050 < L < 6000 on request		≤ 250
Stock lengths	6000 (-0/+50)	25	≤ 250

Lengths supplied: JTA K 38/17-200 (A4)

	Length [mm]	Anchor (no.)	Anchor spacing s
Short pieces	100	2	50
	150	2	100
	200	2	150
	250	2	200
	300 – 450	3	≤ 200
	500 – 650	4	≤ 200
	700 – 850	5	≤ 200
	900 – 1050	6	≤ 200
Cut lengths	1050 < L < 6000 on request		≤ 200
Stock lengths	6000 (-0/+50)	31	≤ 200

**Ordering example
Anchor channels**

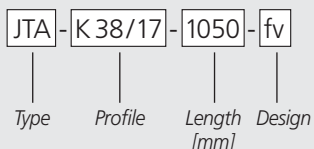

**Ordering example
JORDAHL® bolts type JH**

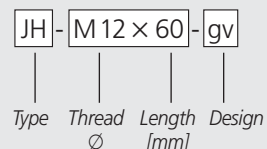

Installation of facade brackets on the anchor channel JTA K 38/17-200. Exact alignment along the anchor channel possible.

JORDAHL® bolts type JH

Bottom view

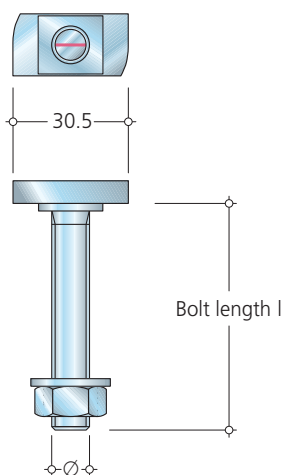

gv 4.6 = electrogalvanized in strength class 4.6
fv 4.6 = hot-dip galvanized in strength class 4.6
fv 8.8 = hot-dip galvanized in strength class 8.8
A4-50 = stainless steel 1.4401/1.4404/1.4571 in strength class 50

Bolt range JH/JUH

Length l [mm]	JH M10	JH M12	JUH M16
20	gv 4.6	gv 4.6	
25		A4-50	A4-50
30	gv 4.6 A4-50	gv 4.6 A4-50	gv 4.6 A4-50
40	gv 4.6 A4-50	fv 4.6 gv 4.6 A4-50	gv 4.6 A4-50
50	gv 4.6 A4-50	gv 4.6 A4-50 ¹⁾	gv 4.6 A4-50 ¹⁾
60	gv 4.6 A4-50	fv 4.6 gv 4.6 A4-50	gv 4.6 A4-50
80	gv 4.6	fv 4.6 gv 4.6 A4-50	gv 4.6 A4-50
100	gv 4.6	fv 8.8 gv 4.6 A4-50	gv 4.6 A4-50
125		gv 4.6	gv 4.6
150	gv 4.6	gv 4.6 A4-50	gv 4.6 A4-50
200		gv 4.6 A4-50	gv 4.6 A4-50

**Locking plates
JGM H, M5-12**



gv, A4
→ p. 56

1) Can be supplied with left-hand or right-hand threads

Permissible bolt loads

under tension, oblique tension or shear load

Type Ø	Recommended tightening torque M _A [Nm] ⁴⁾	Permissible load perm. F ¹⁾ /F _{Rd} [kN]		Permissible bending moment perm. M ²⁾³⁾ /M _{Rd} [Nm]	
		4.6	A4-50	4.6	A4-50
JH M10	15	6.4 9.0	6.4 9.0	10.0 14.0	8.7 12.2
JH M12	25	9.3 13.0	9.3 13.0	17.5 24.5	15.3 21.4
JUH M16	60	17.3 24.2	17.3 24.2	44.4 62.2	38.8 54.3

Notes → p. 40

Associated edge spacings [cm]

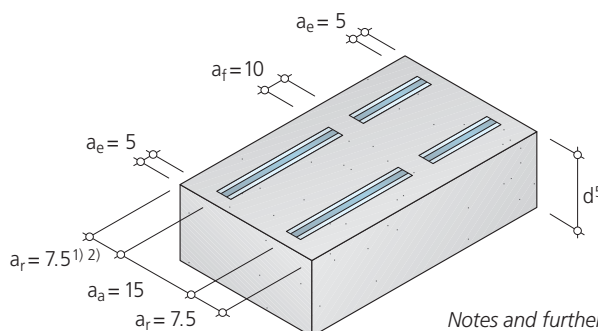

Notes and further minimum spacings → p. 35